

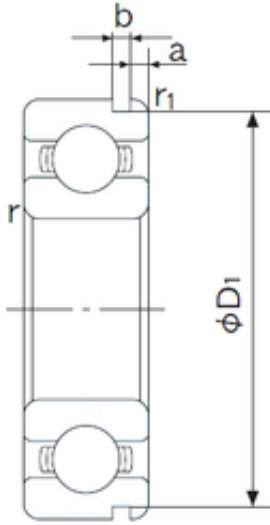

SKF Wheel Bearings DEVELOP MFG.CORP.



65 mm x 85 mm x 10 mm NACHI 6813N deep groove ball bearings

Bearing No. 6813N

6813N Bearing 2D drawings and 3D CAD models

Size	65x85x10 mm
Bore Diameter	65 mm
Outer Diameter	85 mm
Width	10 mm
d	65 mm
D	85 mm
B	10 mm
C	10 mm
a	1.7 mm
b	1.3 mm
r min.	0.6 mm
r1 min.	0.5 mm
D1	82.9 mm
Weight	0.130 Kg
Basic dynamic load rating (C)	11,9 kN
Basic static load rating (C0)	11,5 kN
(Grease) Lubrication Speed	7500 r/min
Bore Type	Cylindrical Bore
Enclosure	Open
Configuration	Single Row
Bore Size	65 mm
Outside Diameter	85 mm
Width	10 mm
Fillet Radius/Chamfer	0.6 mm
r1	0.5 mm



SKF Wheel Bearings DEVELOP MFG.CORP.

Groove Width	1.3 mm
Groove Diameter	82.9 mm
a (max)	1.7 mm
Dynamic Load Rating	11,900 N
Static Load Rating	11,500 N
Limiting Speed - Grease	7,500 rpm
Limiting Speed - Oil	8,700 rpm
Factor fo	16.2
Radial Clearance	0.008 to 0.028 mm
da (min)	69 mm
Da (max)	81 mm
Dx (min)	91 mm
ra (max)	0.6 mm
Cy (max)	2.5 mm